

KODA™ / MC / MR

LED CEILING LIGHT WITH MOOD LIGHTING

ITM. / ART. 1600035
Model: LM57176

CARE & USE INSTRUCTIONS

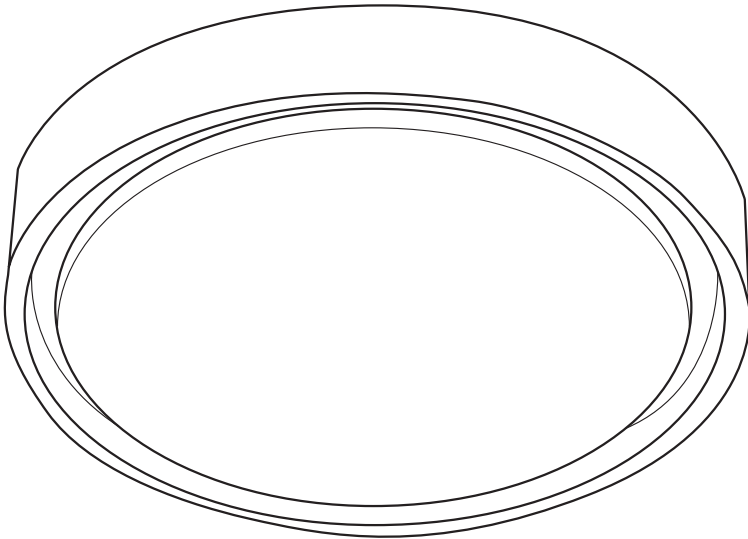

@KodaBuiltOfficial

IMPORTANT, RETAIN FOR FUTURE REFERENCE: READ CAREFULLY

For questions or issues regarding the product, please contact Koda at 1-866-294-9244 (English) or send an email to info@kodabuilt.com. Representatives are available Monday through Friday from 8 AM to 5 PM (Pacific Time).

2975 Red Hill Ave., Ste. 100, Costa Mesa, CA 92626, USA

www.KodaBuilt.com

This LED Ceiling Light is suitable for use in any indoor location (e.g. home, office, warehouse, workshop, garage, and etc.). This light has the following unique features:

- **Built-in Smart Sensor Control System:** This LED Ceiling light is operated by a Smart Sensor Control. It will automatically turn on when motion is detected and will turn off automatically after no movement is detected in the area for preset time.
- **Convenient Wireless Remote:** With the remote control, you can easily adjust the light color, brightness, sensor distance, and the timer for auto-off.
- **Adjustable Light Color:** Along with the remote control, you can easily adjust the light color from warm white to cool white for the best fit for your environment.
- **CRI 90:** The high CRI (color rendering index) helps show the object color more naturally and clearly than lights with lower CRI ratings.
- **Multi-Color Ambiance Glow:** Provides an ambiance glow ring at top, with 16 colors and 4 operation modes. It can run simultaneously with the main Ceiling Light.

Important Safety Instructions:

Please read the following safety information before use.

To reduce risk of fire, electric shock, or injury to persons:

- This light fixture is intended to be installed utilizing a NEC compliant junction box.
- Turn OFF the main power at the fuse or circuit breaker before installing the light fixture or making any electrical connection.
- Make sure this light fixture is adequately grounded. To ensure proper grounding, there must be a separate ground wire (bare copper) contact between this light fixture and the ground connection of your main power supply panel. Do not connect the bare or green insulation fixture ground wire to the black (hot) current-carrying wire or the white (neutral) wire. Connection of the bare or green fixture ground wire to the black or white wires may cause metal parts of the fixture to carry electrical currents, and may cause electrical shock, which could cause serious injury or death.
- Do not connect this fixture to an electrical system that does not provide a means for equipment grounding. Never use a fixture in a two-wire system that is not grounded. Installing a fixture into an electrical system not having a proper grounding could cause metal parts of the fixture to carry electrical currents if any of the fixture wires, wire connections, or splices were to become broken, cut, or loose during the mounting or normal operation of the fixture. Under this condition, anyone coming in contact with the fixture would be subject to electrical shock, which could cause serious injury or death.
- **CAUTION:** A loose wire increases the risk of fire; tighten all connections securely.
- Do not suspend any fixture by the house wires. Suspending a fixture by the house wires and wire connectors may result in the fixture falling, possibly causing personal injury and the danger of electrical shock or fire.
- It is recommended that a qualified electrician perform all wiring connections. All electrical connections must be in accordance with all national and local electrical codes.
- This light fixture is designed for use in a 110 – 120VAC, 60Hz fuse circuit. Not for use on a dimming circuit.
- For indoor use only. Suitable for damp locations.

Warning:

- Failure to disconnect the power supply prior to installation may result in serious injury or death.
- LED light output is strong enough to injure human eyes. Precautions must be taken to prevent looking directly at the LEDs without installing the diffuser (cover) for more than a few seconds.
- If the light fixture is damaged, it shall be exclusively replaced by the manufacturer or the service agent or qualified person in order to avoid a hazard.
- Do not tamper with or attempt to repair the LED component or fixture. The light source is designed for this specific application and should not be serviced by untrained personnel. Contact the customer service department if any servicing is required.
- The warnings, precautions, and instructions discussed in this manual cannot cover all possible conditions and situations that may occur. The operator must understand that common sense and caution are factors which cannot be built into this product, but must be supplied by the operator.
- If using this light fixture in a damp location, this light fixture must be connected to a supply circuit that is protected by a Ground Fault Circuit Interrupter (GFCI) to reduce the risk of personal injury, electrical shock, or death.
- Do not install this LED Ceiling Light with a dimmer. Doing so may damage the driver inside if used with a dimming circuit.
- This device does not have a plug; rewiring is required. If you are unsure how to rewire this light, please contact a qualified electrician to install instead of attempting to rewire yourself.
- Power will still run to the light even after the LED lifespan runs out. Always shut the power from the fuse (breaker) when conducting any type of maintenance on the light.

Cleaning:

- Clean the outside of the fixture with a soft, dry cloth or slightly dampened clean cloth. Never use a cleaner with chemicals, solvents, or harsh abrasives to clean the product.
- Do not spray cleaner directly onto any part of the fixture or LEDs as this may permanently damage the light or its functions.

PACKAGE CONTAINS:

Please lay out all parts and read the instructions prior to installation.

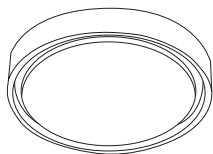

1 x LED Ceiling Light with Mood Lighting



1 x Wireless Remote



1 x Remote Control Setting Label



2 x Screws

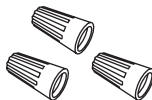

3 x Wire Nuts

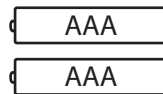

2 x AAA Batteries

Tools Needed (not included):



Phillips-Head Screwdriver

BEFORE INSTALLATION:

Carefully remove the light fixture, mounting package, and wireless remote from the box and check that all parts are included. Do not attempt to assemble the product if any part is missing or damaged.

The outlet box described in this manual is not provided. A standard outlet box needs to be pre-installed in the ceiling, and the power supply wires running to the outlet box need to be rated 120Vac. If an outlet box does not exist, contact a qualified electrician for installation.

Turn OFF the main power at the fuse or circuit breaker before installing the light fixture or making any electrical connection. You may use a non-contact voltage tester to ensure no power running to the wires.

Warning: Failure to disconnect the power supply prior to installation may result in serious injury or death.

INSTALLATION PROCEDURE:

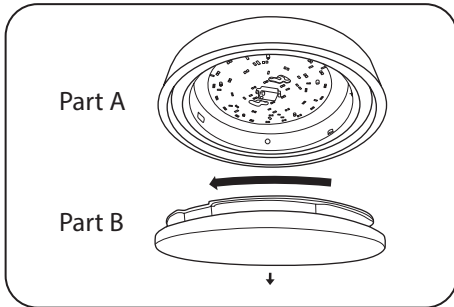

1. Rotate the cover (Part B) counter-clockwise to detach it from the lamp body (Part A).

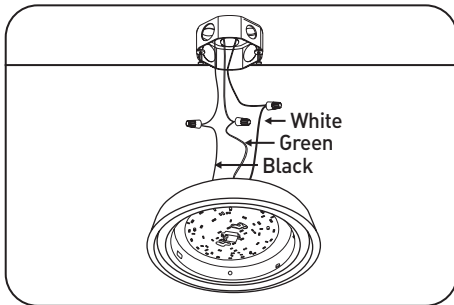

Warning: Never connect the ground wire to the hot or neutral power supply wires.

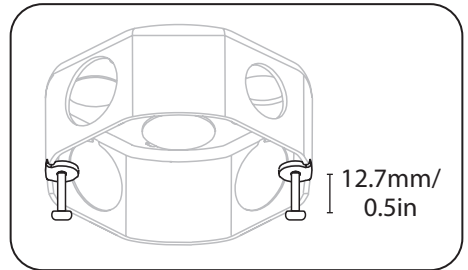

2. Install the mounting screws into outlet box until there is about 12.7 mm / 0.5 in between the ceiling and underside of the screw head.

3. Make the following spliced wire connections using wire nuts:

- White (neutral) supply wire to the common/neutral wire from the outlet box (most likely white).
- Black (hot) supply wire to the hot wire from the outlet box (most likely black or colored).
- Green (ground) supply wire to the ground wire from the outlet box (most likely bare copper, green wire, or green and yellow wire), or wrap around the ground screw if ground wire does not exist.

Screw the wire nuts in a clockwise direction. Make sure no bare wire or wire strands are visible after making the connections.

Consult with a qualified electrician if you have any electrical questions or if your current power supply does not include a ground wire.

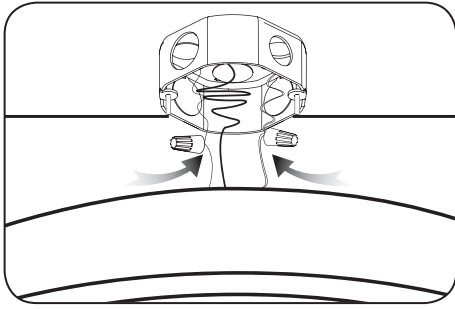

4. Carefully place all the wires and wire connections into the outlet box.

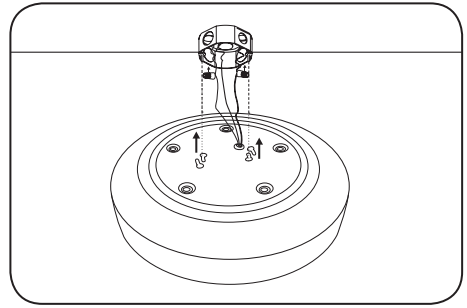

5. Place the lamp body over the outlet box and feed the mounting screws through the inner keyhole slots. There are two pairs of keyhole slots. Please choose the appropriate pair of keyhole slots to fit with the of outlet box.

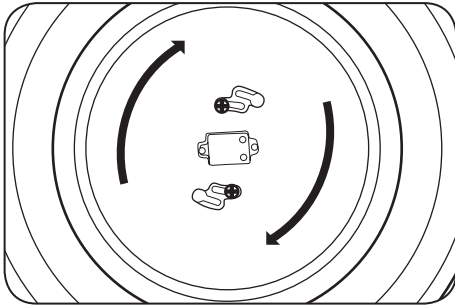

6. Rotate the lamp body clockwise so that the mounting screws slide into the narrow ends of the keyhole slots.

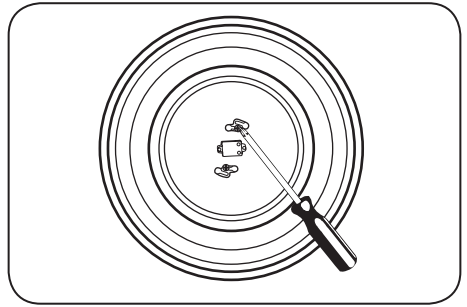

7. Tighten the mounting screws with the screwdriver to ensure the lamp body is secured against the ceiling.

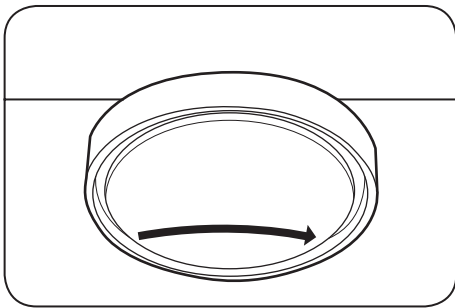

8. Attach the cover to the lamp body and rotate the cover clockwise to secure in place. To ensure complete securement, please rotate the cover until you cannot rotate further.

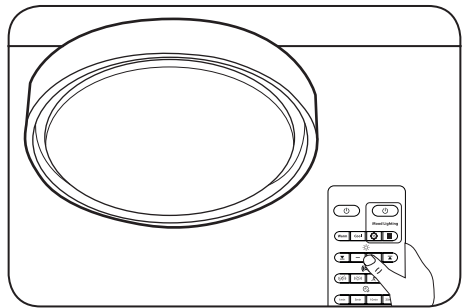

9. When the installation is finished, you can turn on the main power switch and the light will turn on. If the light does not turn on, please refer to the Troubleshooting section on page 9 of this manual.

WIRELESS REMOTE:

Before use, please open the switch cover on the back of the remote, and insert two AAA batteries.

When using the remote, you must point the remote directly at the light to ensure the signals can be sent to the light. When the light receives the remote signal, the light will blink once as a visual confirmation. When the light receives the remote signal of either Ambiance Light Sensor OFF or Motion Sensor OFF, the light will blink twice as a visual confirmation.

Note: This remote uses infrared (IR) to send commands to the LED Ceiling Light. It is possible to control multiple LED Ceiling Lights from one remote as long as the lights are within line-of-sight of the remote to receive commands.

REMOTE SETTINGS:

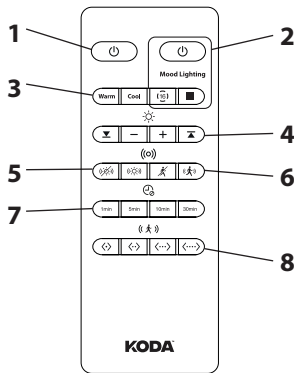

1. Power Button

Press  to turn the light on or off.

NOTE: When you press the power button to turn the light off while the motion sensor is set to on, the light will turn on automatically again when motion is detected.

2. Mood Lighting

 - Turn Mood Lighting on or off.

Note: The mood lighting operation is not controlled by motion sensor.

 - Single color mode, and you can choose the color by pressing the button.

 - Choose from various modes: Glow, Blink, Fade, and Prism. Press the button to go through the different modes available until you find your desired mode.

3. Light Color

You can adjust the light color from 2700K to 5000K by pressing the **Warm** and **Cool** buttons continuously. Press **Warm** for a warmer color and press **Cool** for a cooler color. You may also long-press **Warm** to reach 2700K warm white color gradually, or long-press **Cool** to reach 5000K cool white color gradually.

4. Brightness

You can adjust the brightness from 10% to 100% brightness by pressing **+** continuously. Press **+** to brighten, and press **-** to dim. You may also press **▲** to reach 100% brightness instantly or press **▼** to reach 10% brightness instantly.

5. Ambient Light Sensor

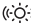

You may activate the ambient light sensor by pressing the  or  buttons.

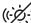
: When the surrounding ambient light is bright, the light will stay off even if motion has been detected. When the surrounding light is less bright and there is motion detected, the light will turn on. The light will turn off automatically when there is no further movement during the preset time.

: The light turns on and off accordingly to the motion sensor setting, and is not affected by surrounding light.

NOTE: If the motion sensor is turned off to disable the motion sensor feature, the Ambient Light Sensor feature will automatically be disabled as well. In this case, the light must be turned on with the included wireless remote or wall switch.

6. Motion Sensor

You can enable or disable the motion sensor by pressing the  or  buttons.

: The light will be function as an ordinary light to operate manually through the wireless remote or wall switch.

: The light will automatically turn on when motion is detected and will turn off automatically when there is no movement in area within the preset time.

7. Time Until Off (no motion)

It is the duration the light stays on before dimming then shutting off completely when there is no motion detected. When the light dims, it will dim to 50% of your preset brightness. You can choose from 1 min, 5 min, 10 min, or 30 min. Please see below settings to select the auto shut-off time most suitable for your location.

Settings:

1 Min Off (last 30 sec dim down)

5 Min Off (last 1 min dim down)

10 Min Off (last 1 min dim down)

30 Min Off (last 1 min dim down)

The light will shut off when there is no motion detected within the preset time.

For example, when choosing 5 min, the light will dim down to 50% of the current brightness when no motion has been detected for 4 minutes and the light will shut OFF when no motion is detected within 1 minute after. Any movement detected within this period will restart the timer and the light will turn on again.

8. Distance

Distance is the maximum motion detection range. You can choose from various settings: Very near, Near, Mid-range and Far. The sensing distance would be ranged from around 1 m - 7m / 3.2 ft - 22.9 ft. You may refer to the table below for the maximum sensing distance for the light installed at a height of 2.4 m / 7.8 ft.

Setting	Maximum Sensing Distance (D)
<·>	1 m - 2 m / 3.2 ft - 6.5 ft
<··>	2 m - 3.5 m / 6.5 ft - 11.4 ft
<···>	3.5 m - 5 m / 11.4 ft - 16.4 ft
<····>	5 m - 7 m / 16.4 ft - 22.9 ft

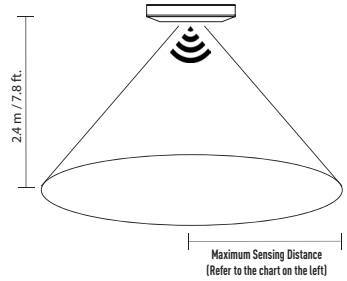

Any movement inside the detection zone will be detected by the motion sensor. Actual sensing distance may be influenced by environment conditions. For example, the sensing distance decreases in an open area free of objects. The distance increases in an area with lots of metallic objects.

Product Specifications:

- Operating Voltage: 120 Vac, 60 Hz
 - Wattage: 24 W Max (Main Light); 6 W Max (Mood Lighting)
 - Light Output: 1600 LM (Main Light)
 - Color Temperature: 2700K – 5000K (Main Light)
 - LED Life Cycles: up to 50,000 hours*
 - CRI: 90 (Main Light)
 - Operating Temperature: 0°C to 40°C / 32°F to 104°F
- *50,000-hour lifespan is for the LED only. Lifespan depends on operating temperature, environmental conditions, etc.



This product is ETL/cETL Listed

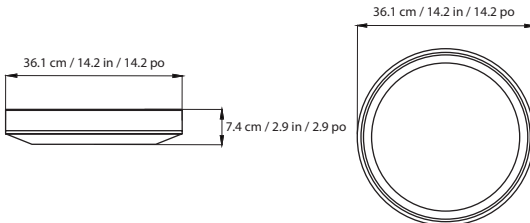

Troubleshooting:

Problem	Possible Cause	Solution
Light does not illuminate. Light does not turn on.	Power is off.	Make sure power supply is on. Ensure the circuit breaker is in the on position as well.
	Faulty wire connection.	Check wiring to ensure all wires are correctly wired and are wired securely.
	Faulty switch.	Test and/or replace switch.
	End of life for the integrated LED.	Replace the LED Ceiling Light.
Light does not turn on during the day.	Make sure the Ambient Light Sensor feature is not disabled (only allowing the light to turn on when the background light is darker).	Enable the Ambient Light Sensor to allow the light to turn on during the day.
Fuse blows or circuit breaker trips when light is illuminated.	The wires are crossed (not wired properly) or the power wire is grounding out.	Turn power to the light off from the breaker. Check the wires to ensure the wires were properly connected. If everything looks correct, contact a qualified electrician to check your wires.
Light settings cannot be changed from the remote.	Batteries not inserted correctly.	Open the battery compartment cover and confirm the batteries were inserted correctly. Replace with new battery if needed.
	Batteries are out.	Replace with two new AAA batteries.
	Remote control is out of range.	Move closer to the LED Ceiling Light to select changes from the remote.
Light is always on.	Continuous movement in the detection zone.	Change the distance setting to shorter distance, such as Very Near.
	Motion sensor has been disabled.	Enable the motion sensor.
	Interference caused by second unit (if two are installed within 2.01m / 6.6ft of each other).	Remove one of the LED Ceiling Lights to another location at least 2.01m / 6.6ft from the first one.
My junction box does not have a ground wire.	The junction box is already grounded.	Look for a ground screw inside the junction box. Wrap the ground wire from the LED Ceiling Light to that ground screw.
Buzzing noise coming from the LED Ceiling Light.	The LED Ceiling Light is connected to a dimmer switch.	This LED Ceiling Light is not compatible with dimmer switches. Turn the dimmer switch to 100% to see if the buzzing goes away. If the buzzing does not go away, you can continue to use the LED Ceiling Light or you will need to remove as the product is not compatible for your setup. If the LED Ceiling Light is not connected to a dimmer switch, please contact customer support.

Warranty:

Koda

This Koda product carries a 3-year warranty against defects in workmanship and materials. This product is not guaranteed against wear or breakage due to misuse and/or abuse.

NOTE: Warranty only applies for North American customers of purchases made in North America.

Conditions of Warranty

If during the 3-year warranty period your new product is found to be defective, Koda will repair such defect, or replace the product, without charge for parts or labor subject to the following conditions:

- All repairs must be performed by Koda.
- All warranty claims must be accompanied by a copy of the sales receipt or bill of sale.
- The equipment must not have been altered or damaged through negligence, accident, improper operation, or failure to follow the product instructions for installation, use, or care.
- The replacement of parts is excluded from the warranty when replacement is necessary due to normal wear and tear.
- Repair or replacement parts supplied by Koda under this warranty are protected only for the unexpired portion of the original warranty.
- This is a "repair or replace" warranty only, and does not cover the costs incurred for the installation, removal or reinstallation of the product.

OWNER'S RESPONSIBILITIES: Koda will make every effort to provide warranty service within a reasonable period of time. SHOULD YOU HAVE ANY QUESTIONS ABOUT SERVICE RECEIVED OR IF YOU WOULD LIKE ASSISTANCE IN OBTAINING SERVICE, PLEASE CALL TOLL FREE 1.866.294.9244 DURING REGULAR BUSINESS HOURS MONDAY THROUGH FRIDAY 9:00 AM TO 5:00 PM PST.

NOTE: Toll Free # is for North America Customers ONLY. See Customer service section for customer contact numbers for other regions/offices.

For customer service and technical support, please call us at 1.866.294.9244 or email us at info@kodabuilt.com. If at that time it is determined that a replacement unit is needed, the support representative will issue a Return Authorization and instruct on how to get a new unit.

Koda makes no other warranty of any kind aside from the limited express warranty stated herein.

DISCLAIMER OF WARRANTIES, INCLUDING WARRANTY OF MERCHANTABILITY AND WARRANTY OF FITNESS FOR PARTICULAR PURPOSE: EXCEPT AS SPECIFICALLY SET FORTH HEREIN, NO WARRANTY OR REPRESENTATION, EXPRESS OR IMPLIED, IS MADE AS TO THE LED CEILING LIGHT. KODA AND/OR ITS AFFILIATES EXPRESSLY DISCLAIMS, WITHOUT LIMITATION, ANY STATUTORY WARRANTIES AND ALL IMPLIED WARRANTIES, INCLUDING ANY IMPLIED WARRANTY OF MERCHANTABILITY OR FITNESS FOR A PARTICULAR PURPOSE.

FCC / IC Compliance Statement:

LED Ceiling Light

Model: LM57176

Responsible Party:

Koda

Address: 2975 Red Hill Ave., Ste. 100, Costa Mesa, CA 92626, USA

Tel: 1-866-294-9244

This device complies with Part 15 of the FCC rules and Industry Canada license-exempt RSS standard(s). Operation is subject to the following two conditions: (1) this device may not cause harmful interference, and (2) this device must accept any interference received, including interference that may cause undesired operation.

Warning: Changes or modifications to this unit not expressly approved by the party responsible for compliance could void the user's authority to operate the equipment.

The manufacturer is not responsible for any radio or TV interference caused by unauthorized modifications or change to this equipment. Such modifications or change could void the user's authority to operate the equipment.

This equipment has been tested and found to comply with the limits for a Class B digital device, pursuant to part 15 of the FCC Rules. These limits are designed to provide reasonable protection against harmful interference in a residential installation. This equipment generates, uses and can radiate radio frequency energy and, if not installed and used in accordance with the instructions, may cause harmful interference to radio communications. However, there is no guarantee that interference will not occur in a particular installation. If this equipment does cause harmful interference to radio or television reception, which can be determined by turning the equipment off and on, the user is encouraged to try to correct the interference by one or more of the following measures:

- Reorient or relocate the receiving antenna.
- Increase the separation between the equipment and receiver.
- Connect the equipment into an outlet on a circuit different from that to which the receiver is connected.
- Consult the dealer or an experienced radio/TV technician for help.

The device has been evaluated to meet general RF exposure requirement.

To maintain compliance with FCC/IC's RF exposure guidelines, this equipment should be installed and operated with a minimum distance of 20cm between the radiator and your body.

CAN ICES-005(B) / NMB-005(B)

The Facebook logo is a trademark of Facebook, Inc.

The Instagram logo is a trademark of Instagram, Inc.

DISTRIBUTED BY:
COSTCO WHOLESALE CORPORATION
P.O. BOX 34535
SEATTLE, WA 98124-1535
USA
1-800-774-2678
WWW.COSTCO.COM

MADE IN CHINA

 Have a comment or question? Email us at info@kodabuilt.com
or visit us online at www.KodaBuilt.com

KODA™

A Horizon Brands Company
2975 Red Hill Ave., Ste. 100, Costa Mesa, CA 92626, USA | Tel: 1-866-294-9244
© 2019 Koda. All rights reserved.