

LED CUBE LIGHTS

Model: LM56357

CARE & USE INSTRUCTIONS

IMPORTANT, RETAIN FOR FUTURE REFERENCE: READ CAREFULLY

For questions or issues regarding the product, please contact Winplus at 1-866-294-9244 (English) or send an email to info@winplususa.com.

Representatives are available Monday through Friday from 8 AM to 5 PM (Pacific Time).

820 South Wanamaker Ave., Ontario, CA 91761, USA

www.winplus.com

SAFETY INSTRUCTIONS:

Read this manual thoroughly before first use and keep it in a safe place for future reference. To reduce injury to persons:

- This product contains small parts.
- Protect the LED Cube Light from excessive heat.
- Suitable for indoor and outdoor use in dry locations.
- Do not submerge any parts of this product in water or put in a dishwasher.
- See Battery Safety for additional warnings and precautions.

CLEANING:

Clean the outside of the fixture with a soft, dry cloth or slightly dampened clean cloth.

Never use a cleaner with chemicals, solvents, or harsh abrasives to clean the product.

WARNING:

- LED light output is strong enough to injury human eyes. Precautions must be taken to prevent looking directly at the LEDs with diffuser (cover) removed for more than a few seconds.
- Do not tamper with or attempt to repair the LED component. The light source is designed for this specific application and should not be serviced by untrained personnel. Contact the customer service department if any servicing is required.
- The warnings, precautions, and instructions discussed in this manual cannot cover all possible conditions and situations that may occur. The operator must understand that common sense and caution are factors which cannot be built into this product, but must be supplied by the operator.
- The small parts in the product may present a choking hazard. Seek medical assistance immediately if any parts are swallowed.

PACKAGE CONTAINS:

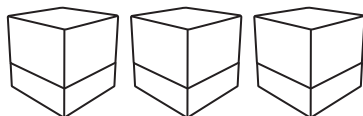

3 x LED Cube Lights



9 x AAA Batteries

Tools Needed (not included)

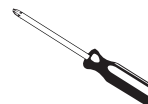

Phillips-Head Screwdriver

TECHNICAL SPECIFICATION:

- Input: 3 x 1.5V AAA batteries
- LED: 3 x Warm White, 1 x RGB
- Light output at White High: 100 lm (without diffuser); 50 lm (with diffuser)
- IPX5 for splash-proof durability
- Run time *
 - White High: 8 hrs
 - Changing Color: 10 hrs
- *Based on maximum duration of perceived brightness. Run time will vary by battery type.
- Operating temperature: 0°C to 40°C / 32°F to 104°F
- Product weight: 105 g / 0.23 lb (without batteries)
- For indoor or outdoor use in dry locations

Dimensions:

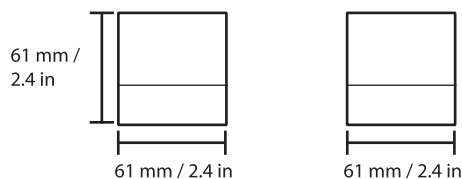

BATTERY SAFETY:

- Swallowing the batteries may lead to serious injury or death. If swallowed go straight to a medical emergency room.
- Clean batteries and the battery contacts before inserting if necessary with a clean, dry cloth.
- Always purchase the correct size and grade of batteries that are most suitable for the intended use.
- Ensure the batteries are installed correctly with regard to polarity (+ and -). Wrongly inserted batteries may cause battery leakage and cause damage to the device or other harmful.
- Remove batteries when they are not used for an extended period of time.
- Remove used batteries promptly.
- Keep batteries out of children's reach.
- Do not charge, dismantle, throw into fire, or short-circuit the batteries.
- If a battery has leaked, avoid contact with skin, eyes, and mucous membranes. Promptly rinse any affected area with water and seek medical assistance.
- Do not mix old and new batteries.
- Always use the same type of batteries. Do not mix alkaline, standard (Carbon-Zinc), or rechargeable (Nickel Cadmium) or (Nickel Metal Hydride) batteries.

BATTERY INSTALLATION:

1. Unscrew and open the batter door with a screwdriver.

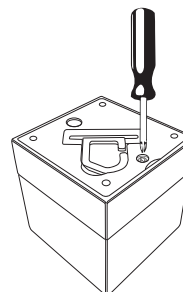

2. Insert three (3) AAA batteries with the correct polarity and position.

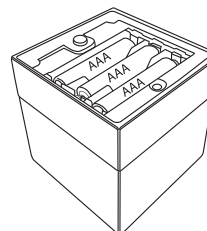

3. Align the battery door into place and secure with the screw. Make sure not to over-tighten the screw.

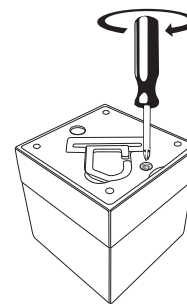
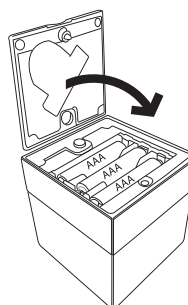

USING WITH HOOK:

Flip the hook for positioning or hanging.

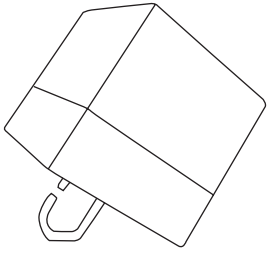

Placing with hook

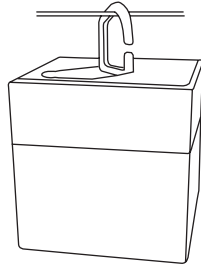

Hanging

OPERATION MODES:

- White Low
- White Medium
- White High
- Color Changing - Automatically changes color every few seconds.
- Fixed Color – While in Color Changing mode, press the mode button once to lock the present color in place.

Mode / Power Button

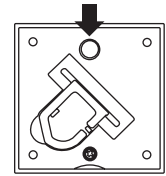

Press the mode/power button to go through the different modes offered. Press once to go to the next mode. The sequence of the light is as follows: White Low -> White Medium -> White High -> Color Changing -> Fixed Color -> OFF

Turn OFF the LED Cube Light when not in use. Remove the batteries from the product if you are planning to store for a long period of time.

FCC / IC Compliance Statement:

This device complies with Part 15 of the FCC rules. Operation is subject to the following two conditions: (1) this device may not cause harmful interference, and (2) this device must accept any interference received, including interference that may cause undesired operation.

Warning: Changes or modifications to this unit not expressly approved by the party responsible for compliance could void the user's authority to operate the equipment. The manufacturer is not responsible for any radio or TV interference caused by unauthorized modifications or change to this equipment. Such modifications or change could void the user's authority to operate the equipment.

This equipment has been tested and found to comply with the limits for a Class B digital device, pursuant to part 15 of the FCC Rules. These limits are designed to provide reasonable protection against harmful interference in a residential installation. This equipment generates, uses and can radiate radio frequency energy and, if not installed and used in accordance with the instructions, may cause harmful interference to radio communications. However, there is no guarantee that interference will not occur in a particular installation. If this equipment does cause harmful interference to radio or television reception, which can be determined by turning the equipment off and on, the user is encouraged to try to correct the interference by one or more of the following measures:

- Reorient or relocate the receiving antenna.
- Increase the separation between the equipment and receiver.
- Connect the equipment into an outlet on a circuit different from that to which the receiver is connected.
- Consult the dealer or an experienced radio/TV technician for help.

CAN ICES-005 (B) / NMB-005 (B)

WARRANTY:

Winplus North America
Limited warranty

This Winplus product carries a 1 year warranty against defects in workmanship and materials. This product is not guaranteed against wear or breakage due to misuse and/ or abuse.

NOTE: Warranty only applies for North American customers of purchases made in North America.

Conditions of Warranty

If during the 1 year warranty period your new product is found to be defective, Winplus North America will repair such defect, or replace the product, without charge for parts or labor subject to the following conditions:

- All repairs must be performed by Winplus North America.
- All warranty claims must be accompanied by a copy of the sales receipt or bill of sale.
- The equipment must not have been altered or damaged through negligence, accident, improper operation, or failure to follow the product instructions for installation, use, or care.
- The replacement of parts is excluded from the warranty when replacement is necessary due to normal wear and tear.
- Repair or replacement parts supplied by Winplus North America under this warranty are protected only for the unexpired portion of the original warranty.
- This is a "repair or replace" warranty only, and does not cover the costs incurred for the installation, removal or reinstallation of the product.

OWNER'S RESPONSIBILITIES: Winplus North America will make every effort to provide warranty service within a reasonable period of time. SHOULD YOU HAVE ANY QUESTIONS ABOUT SERVICE RECEIVED OR IF YOU WOULD LIKE ASSISTANCE IN OBTAINING SERVICE, PLEASE CALL TOLL FREE 1.866.294.9244 DURING REGULAR BUSINESS HOURS MONDAY THROUGH FRIDAY 9:00 AM TO 5:00PM.

NOTE: Toll Free # is for North America customers ONLY. See customer service section for customer contact numbers for other regions/offices.

For customer service and technical support, please call us at 1.866.294.9244 or email us at info@winplususa.com. If at that time it is determined that a replacement unit is needed, the support representative will issue a Return Authorization and instruct on how to get a new unit.

Winplus North America makes no other warranty of any kind aside from the limited express warranty stated herein.

DISCLAIMER OF WARRANTIES, INCLUDING WARRANTY OF MERCHANTABILITY AND WARRANTY OF FITNESS FOR PARTICULAR PURPOSE: EXCEPT AS SPECIFICALLY SET FORTH HEREIN, NO WARRANTY OR REPRESENTATION, EXPRESS OR IMPLIED, IS MADE AS TO THE LED CUBE LIGHT. WINPLUS NORTH AMERICA AND/OR ITS AFFILIATES EXPRESSLY DISCLAIMS, WITHOUT LIMITATION, ANY STATUTORY WARRANTIES AND ALL IMPLIED WARRANTIES, INCLUDING ANY IMPLIED WARRANTY OF MERCHANTABILITY OR FITNESS FOR A PARTICULAR PURPOSE.



Have a comment or question? Email us at info@winplususa.com or visit us online at www.winplus.com

WINPLUS®

820 South Wanamaker Ave., Ontario, CA 91761, USA | Tel: 1-866-294-9244
© 2018 Winplus North America Inc. All rights reserved.